

**TOOLS REQUIRED:**

- Power Mitre saw
- Power Drill
- Large flat screwdriver
- Nylon / rubber hammer (pref. Dead blow)
- Cutting knife
- Garden Secateurs
- Spirit level
- Tape measure

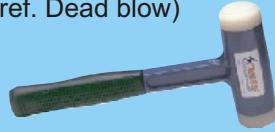

**PREPARATION INFORMATION:**

**Frame size:** The frame is always measured to the total outside dimension. The width of the frame is 20mm reducing the total visual area by 40mm.

**Print size:** Add 50mm of print bleed and 100mm of extra unprinted material to the required finished size of the graphic. Add fine alignment marks to assist positioning during installation.

**Material spec:** Coated PVC banner material (approx. 360gsm - max 550gsm), PVC mesh, various textiles. For a full list of compatible textiles and manufacturers see Guide Sheet SD-04

**NOTE:** Some laminate PVC banner and some heavier duty materials are not recommended. For specific material compatibility, please contact us.

**Sizing the frame:**

- 1 Slide the plastic tension strip into the aluminium channel and fix in place with masking tape.



- 2 Cut and mitre lengths to the outside dimensions of the required frame. Drill holes every 300mm for fixing.
- 3 Use the secateurs to cut back the "clip in legs" on the tension strip by about 5mm on the mitre corners. This leaves more space for excess material in the corner

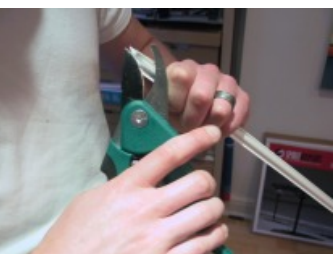

**TIP :** Cut 10 to 15 pieces of 50mm each from any left over tension strip. These will be used later in the installation process. Alternatively ask us to supply an installation pack.

**Fitting the aluminium channel:**

- 1 SPiRITFlex™ can be fitted to a range of structures including masonry, existing signage, studwall etc.



- 2 Use appropriate fixings to firmly secure the aluminium frame to the base structure. Space fixings 300mm apart.

If the frame is being fitted to corrugated cladding or any other poorly supported structure, we recommend that a frame of aluminium or timber is installed first. This gives the SpiritFlex™ sufficient support when spanning gaps on the cladding.

It is very important that the frame is firmly secured. Any vibration can cause the frame to work loose during the later tensioning stages.



*SpiritFlex™ Banner System on corrugated cladding*

**Fitting and tensioning the graphic:**

Initial tension is applied by hand to pull the banner flat over the aluminium channel. The tension strip will then perform any additional tensioning. The amount of hand tension required depends on the size of the graphic and the type of material used. Generally a larger banner has more stretch in the material which requires more tension. We recommend starting with the top edge, then the sides, before finishing with the bottom edge.

*...contd on pg. 2*

**ANY QUESTIONS?**

Telephone : +44 20 8542 7279

Email : [info@spirit-displays.com](mailto:info@spirit-displays.com)

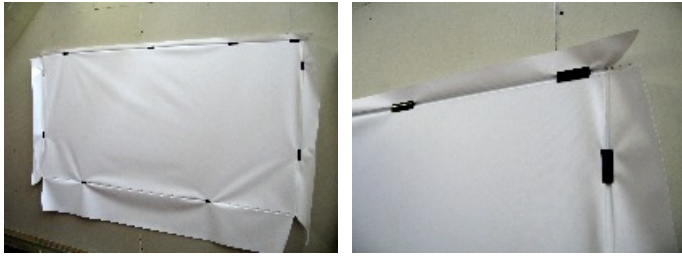

1. Starting at the top, “tack” the banner into the frame using the 50mm offcut pieces. Place them approx. 1 metre apart. Follow the alignment marks to keep the banner level and correctly positioned. Do not apply any tension at this point. Let the banner hang flat. For larger banners and outdoor installations, peg the banner out on all four sides. This will keep it in position. Adjustments are easily made at this stage to ensure the banner is square and evenly tensioned. Take your time to get this stage right. It will save you later on.

2. Now insert the full length tension strip(s) along the top edge with a mallet / nylon hammer. Always make sure the outer leg goes into the channel first, and then hammer the strip to insert the inner leg. Remove the 50mm pieces with a flat screwdriver as you work along. To prevent any “puckering” along the top, pull the face flat just ahead of the insertion point while hammering in the tension strip. Make sure the top tension strip is properly seated before continuing.



**TIP : During this stage, it is important to follow the alignment marks to keep the banner square and level.**

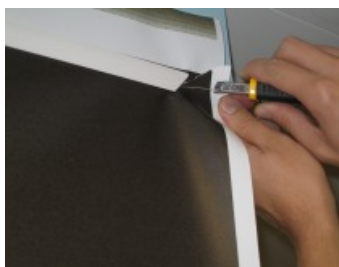

3. Start in the top corner of the first vertical side. Using the cutting knife, cut a small wedge out of the banner in the corner to allow the tension strip to fit more tightly into the mitre join. Use the mallet to insert the tension strip into the channel. Make

sure they are butted together in the corner.

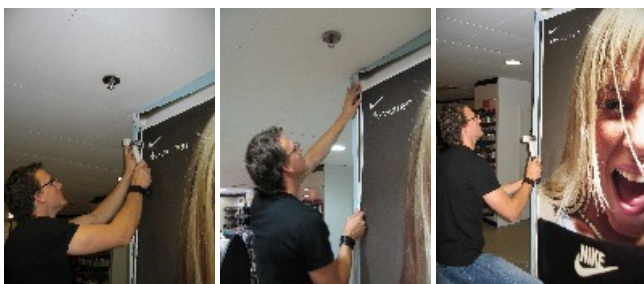

**Take care not to over-tension the first side. Make sure the banner remains square by following your alignment marks.**

4. Move to the top corner of the second vertical side. Final tensioning starts at this stage. Cut the banner and butt up the tension strips as before. Hammer in the first 100mm. Now apply tension by hand approx. 400mm ahead of the insertion point. Pull at an angle away from the frame to smooth out any wrinkles. Work in the full tension strip in this manner.



**TIP : Be sure to insert the outer leg of the tension strip first to get the best tension.**

5. Cut out the banner material in the bottom two corners and insert the tension strip in the same way as in point 4.

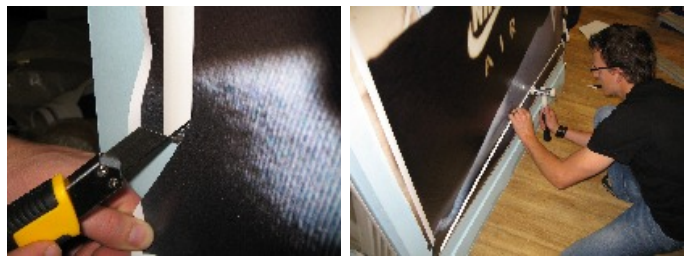

**After tensioning the first three sides, there may still be some slight “bulges” in the face. These should come out by the time the bottom has been inserted. If not, go back, lever out the tension strip with a flat screwdriver and re-tension until you are satisfied with the result.**

**Trimming:**

1. Once all the tension strips are in place and you are satisfied with the tension on the banner, use a cutting knife to trim any excess material around the edge of the frame. You have completed your SpiritFlex™ Frame.



The plastic frame trim can be covered with an aluminium angle profile or timber surround to fit in with the design of the sign or interior decor. The choices are up to your creativity and imagination!